

CROSSING – NAVIGABLE WATERWAYS

DRAWING NUMBER	SHT.	DRAWING TITLE	DWG REV.	BOM REV.
C-24-22.01	1	CROSSING NAVIGABLE WATERWAYS	A	-
C-24-22.01	2	CROSSING NAVIGABLE WATERWAYS	B	-
C-24-22.01	3	CROSSING NAVIGABLE WATERWAYS	A	-
C-24-22.01	4	CROSSING NAVIGABLE WATERWAYS	B	-
C-24-22.02	1	LETTER OF APPLICATION	A	-
C-24-22.03	1	OVERHEAD CROSSING PLAN	0	-

SaskPower - DISTRIBUTION STANDARDS

DRN.	DESIGN CHK.	APPROVAL	INDEX
CHKD.			
DATE	DATE	DATE	
DATE OF ISSUE: 2009/06/29		DRAWING NO: C-24-22-INDEX	SHEET 1 of 1 REV. C

NAVIGABLE WATER CROSSINGS

REASON FOR SPECIFICATION

THE ADVENT OF ARTIFICIALLY CREATED WATERS, SUCH AS LAKES AND RESERVOIRS, HAS BROUGHT ABOUT A SERIOUS CHANGE IN RECREATIONAL HABITS. A SPECIFICATION FOR CROSSING NAVIGABLE WATERS, ESPECIALLY FOR OVERHEAD POWER LINES, HAS BEEN PROMPTED BY A MUSHROOMING CONCERN OVER WATERS FREQUENTED BY SAILING VESSELS. THE NUMBER OF SUCH VESSELS INVOLVED, AND THE BODY OF WATER BECOMES LARGER, THE MASTS EXTEND CORRESPONDINGLY HIGHER. WHEN RIGGED ONTO A BOAT, THE RECENT SAILING VESSEL MASTS HAVE APPROACHED A HEIGHT OF 12.2 METERS.

APPLICABLE PUBLICATIONS

THE FEDERAL GOVERNMENT HAS ACCORDINGLY ISSUED PUBLICATIONS, VIA MINISTER OF TRANSPORT, THAT ARE DESIGNED TO PROTECT THE PUBLIC RIGHT OF NAVIGATION IN NAVIGABLE WATERS. TO MINIMIZE ANY POTENTIAL HAZARD, SASKPOWER IS OBLIGATED TO COMPLY WITH THE FEDERAL GOVERNMENT'S ATTEMPT TO PROTECT THE PUBLIC. HEAD OFFICE WILL PROVIDE COPIES OF THE FOLLOWING PUBLICATIONS TO EACH AREA OFFICE WHERE APPLICATION STAFF SHOULD BECOME KNOWLEDGEABLE IN APPLYING THEM, PRIOR TO ANY PROPOSED NAVIGABLE WATER CROSSING:

1. NAVIGABLE WATERS PROTECTION ACT (NWPA)
2. NAVIGABLE WATERS WORKS REGULATIONS
3. NAVIGABLE WATERS PROTECTION ACT – APPLICATION GUIDE

AUTHORIZATION PRIOR TO CONSTRUCTION

UNDER THE PROVISION OF THE NAVIGABLE WATERS PROTECTION ACT, ALL CROSSINGS OF NAVIGABLE WATERS, BY EITHER OVERHEAD CONDUCTOR OR CABLE, MUST BE (1) FORMALLY APPROVED OR (2) DECLARED AS AN EXEMPTION BY THE APPROPRIATE AGENT OF THE MINISTER OF TRANSPORT, PRIOR TO CONSTRUCTION OF THE CROSSING. SECTION 5(1) OF THE ACT MAKES IT ILLEGAL TO CONSTRUCT SUCH A CROSSING WITHOUT THE PROPER AUTHORITY.

SaskPower - DISTRIBUTION STANDARDS

DRN.	DESIGN CHK.	APPROVAL	CROSSINGS NAVIGABLE WATERWAYS	
CHKD.				
DATE	DATE	DATE		
DATE OF ISSUE: 2009/06/29		DRAWING NO: C-24-22.01	SHEET 1 of 4	REV. A

NAVIGABLE WATERS DEFINED AS

“NAVIGABLE WATERS” INCLUDES ANY BODY OF WATER CAPABLE IN ITS NATURAL STATE OF BEING NAVIGATED BY FLOATING VESSELS OF ANY DESCRIPTION FOR THE PURPOSE OF TRANSPORTATION, RECREATION, OR COMMERCE. IT ALSO INCLUDES A CANAL AND ANY OTHER BODY OF WATER CREATED OR ALTERED FOR PUBLIC USE. AS A RESULT OF THE CONSTRUCTION OF ANY WORK, AS WELL AS ANY WATERWAY FOR PUBLIC PURPOSES OR BY THE PUBLIC HAVING ACQUIRED THE RIGHT TO NAVIGATE THROUGH LONG USE.

NOTE: THE PRECEDING DEFINITION IS USED FOR ADMINISTRATIVE PURPOSES ONLY AND IS NOT TO BE CONSTRUED AS A LEGAL DEFINITION OF NAVIGABILITY. NAVIGABILITY IS A MATTER OF FACT AND NOT OF LAW. THE AUTHORITY TO DETERMINE NAVIGABILITY OF WATERWAYS RESTS WITH THE MINISTER OF TRANSPORT

APPLICATION FOR CROSSING

BEFORE THE PROJECT IS STARTED, CONTACT THE TRANSPORT CANADA OFFICE LISTED BELOW TO DISCUSS IN GENERAL TERMS THE CONSTRUCTION OF THE WORK YOU ARE PROPOSING TO BUILD. A NAVIGABLE WATERS PROTECTION (NWP) OFFICER WILL ASSIST YOU IN DETERMINING WHAT INFORMATION AND DOCUMENTATION IS REQUIRED FOR PREPARING AND SUBMITTING. THIS WILL ASSIST IN MAKING A COMPLETE SUBMISSION AND AVOID UNNECESSARY DELAYS IN PROCESSING.

THE REGION ENGINEERING OFFICE WILL BE RESPONSIBLE FOR MAKING APPLICATIONS UNDER NAVIGABLE WATER PROTECTION ACT. A CURRENT APPLICATION GUIDE SHOULD BE OBTAINED BEFORE PROCEEDING. APPLICATIONS SHOULD BE SUBMITTED TO:

TRANSPORT CANADA
MARINE – NWP PROGRAM
P.O. BOX 8550
344 EDMONTON STREET
WINNIPEG MB
R3C 0P6
PHONE: 204-984-7494

THE FOLLOWING INFORMATION SHALL BE INCLUDED IN THE LETTER OF APPLICATION:

APPLICANT:

- NAME OF APPLICANT AND, IF APPLICABLE, NAME OF AGENT ACTING ON BEHALF OF THE APPLICANT.
- ADDRESS, PHONE NUMBER, AND FAX NUMBER.

***SaskPower* - DISTRIBUTION STANDARDS**

DRN.	DESIGN CHK.	APPROVAL	CROSSINGS NAVIGABLE WATERWAYS	
CHKD.				
DATE	DATE	DATE		
DATE OF ISSUE: 2009/06/29		DRAWING NO: C-24-22.01	SHEET 2 of 4	REV. B

DETAILS OF THE WORK:

- PROPOSED CONSTRUCTION SCHEDULE
- DESCRIPTION OF WORK INCLUDING DIMENSIONS
- STATUS OF WORK (EXISTING, PROPOSED OR BOTH)
- NAME OF WATERWAY WHERE THE WORK IS OR WILL BE LOCATED INCLUDING WIDTH AND DEPTH.
- CHART AND TOPOGRAPHIC MAP NUMBERS.
- LATITUDE AND LONGITUDE OF THE WORK SITE.
- LEGAL DESCRIPTION (SECTION, LOT NUMBER, CONCESSION, COUNTY/TOWNSHIP, CITY/TOWN, PROVINCE, ETC.)
- ENVIRONMENTAL ASSESSMENT DOCUMENTS IF APPLICABLE.
- IDENTIFICATION OF UPLAND PROPERTY OWNERS.
- METHOD OF CONSTRUCTION (EQUIPMENT TO BE USED, TEMPORARY CONSTRUCTION THAT MAY IMPACT ON NAVIGATION).

WATERLOT LEASE/PERMIT:

- IF A WATERLOT LEASE/PERMIT HAS BEEN ATTAINED, PROVIDE THE LEGAL DESCRIPTION AND DIMENSIONS OF THE LEASE/PERMIT AREA.
- IF SASKPOWER IS NOT THE OWNER OF THE UPLAND PROPERTY FACING THE WORK, PROVIDE UPLAND OWNER'S WRITTEN CONSENT.

PLANS:

- DRAWINGS INCLUDING ALL DETAIL OF ADJACENT WORKS IN RELATION TO PROPOSAL. IF THE DRAWINGS ARE LARGER THAN 11" X 17", SUBMIT TEN (10) COPIES. FOR DRAWINGS 11" X 17" OR SMALLER, ONE (1) COPY WILL BE SUFFICIENT.
- REQUIRED SETS OF PLANS AS DIRECTED BY THE NWP OFFICER.
- INDICATE IF ANY OF THE PLANS HAVE BEEN REGISTERED/DEPOSITED, AND IF SO, INDICATE THE REGISTRATION/DEPOSIT NUMBER.
- TO AVOID HAVING TO RE-DEPOSIT AND RE-ADVERTISE, DO NOT DEPOSIT AND ADVERTISE UNTIL ADVISED TO DO SO BY THE NWP OFFICER.
- IDENTIFY WHICH OTHER GOVERNMENT REGULATORY AGENCIES THESE PLANS HAVE BEEN SUBMITTED TO.

ALL OF THE INFORMATION SHOULD BE PROVIDED AT THE OUTSET TO AVOID ANY DELAY IN PROCESSING THE APPLICATION. FOR SIMILAR REASONS, THE INFORMATION PROVIDED SHOULD BE CORRECT. THE CROSSING MUST ALSO BE CONSTRUCTED IN ACCORDANCE WITH THE APPROVED DRAWING AND PLAN OF THE CROSSING, AS BUILT, WILL BE CONSIDERED AN UNAPPROVED CROSSING.

IF THERE IS ANY DOUBT, IT IS ADVISABLE TO PROCEED WITH AN APPLICATION UNDER THE ACT. DO NOT OVERLOOK ADJACENT LAND AND WATER INLET AREAS USEABLE FOR RIGGING AND LAUNCHING OF SAILBOATS OR THAT MAY PROVIDE A SUITABLE REFUGE.

SaskPower - DISTRIBUTION STANDARDS

DRN.	DESIGN CHK.	APPROVAL	CROSSINGS NAVIGABLE WATERWAYS	
CHKD.				
DATE	DATE	DATE		
DATE OF ISSUE: 2009/06/29		DRAWING NO: C-24-22.01	SHEET 3 of 4	REV. A

EXEMPTIONS

SECTION 5(2) OF THE ACT EXEMPTS ALL WORKS (EXCEPT A BRIDGE, BOOM, DAM, CAUSEWAY) THAT, IN THE OPINION OF THE MINISTER, DOES NOT INTERFERE SUBSTANTIALLY WITH NAVIGATION. IF YOU BELIEVE THE WORK YOU PROPOSE TO CONSTRUCT OR HAVE CONSTRUCTED MAY COME UNDER THIS EXEMPTION, CONTACT THE TRANSPORT CANADA OFFICE MENTIONED PREVIOUS.

FULL SERVICE WATER LEVEL

THE FULL SERVICE WATER LEVEL MAY BE OBTAINED BY CONTACTING:

HYDROLOGY BRANCH
SASKATCHEWAN WATER CORP.
3RD FLOOR, 111 FAIRFORD ST. E.
MOOSE JAW, SK
S6H 7X9
PH: 306-694-3900

INDICATE YOUR REASON FOR REQUESTING THE LEVEL SO THAT YOU WILL BE GIVEN THE LEVEL APPLICABLE TO THE NORMAL RECREATION SEASON.

CONTACTING AIR SERVICES BRANCH

WHEN MAKING APPLICATION, THE REGION ENGINEERING OFFICE SHOULD AT THE SAME TIME CONTACT:

REGIONAL MANAGER, AIR NAVIGATION REQUIREMENTS
TRANSPORT CANADA
CANADA PLACE
1100, 9700 JASPER AVENUE
EDMONTON, AB T5J 4E6
PH: (780) 495-5180

THE LETTER TO THE AVIATION BRANCH SHOULD INCLUDE FOUR COPIES OF THE PLAN AND SHOULD REQUEST CONCURRENCE IN THE CROSSING AND ANY SPECIAL REQUIREMENTS THAT MAY BE RECOMMENDED BY THAT BRANCH. THE LETTER SHOULD ALSO NOTE ANY SPECIAL CIRCUMSTANCES CONCERNING THE LOCATION OF THE CROSSING, SUCH AS THE FACT THAT THE STRUCTURES ARE OBSCURED FROM THE AIR BY TREES OR BUILDINGS.

NUMBERING OF CROSSING

IF AN AREA DECIDES TO ALLOCATE RESPECTIVE CROSSING NUMBERS, THEY SHOULD BE PREFIXED BY SIGNIFICANT AREA LETTERS TO DISTINGUISH DUPLICATION FROM NUMBERS THAT MAY BE USED BY OTHER AREAS.

EXAMPLE NUMBERING – R-XX, S.C.-XX, S-XX, OR P.A.-XX

***SaskPower* - DISTRIBUTION STANDARDS**

DRN.	DESIGN CHK.	APPROVAL	CROSSINGS NAVIGABLE WATERWAYS	
CHKD.				
DATE	DATE	DATE		
DATE OF ISSUE: 2009/06/29		DRAWING NO: C-24-22.01	SHEET 4 of 4	REV. B

LETTER OF APPLICATION

TRANSPORT CANADA
 MARINE – NWP PROGRAM
 P.O. BOX 8550
 344 EDMONTON STREET
 WINNIPEG, MB
 R3C 0P6
 PHONE: 204-984-7494

LANDS FILE # _____ APPLICANT FILE # _____ APPLICANT: _____ MAILING ADDRESS: _____ _____ _____	NWP FILE # <u>8200-</u> _____ APPLICANT'S REP: _____ MAILING ADDRESS: _____ _____ _____ CONTACT: _____ TELEPHONE: _____ FAX: _____ EMAIL: _____
--	---

PROJECT INFORMATION

WATERWAY: _____ A TRIBUTARY OF: _____

WORK DESCRIPTION: _____

LEGAL DESCRIPTION OF SITE: _____

STREET ADDRESS AT SITE: _____

LATITUDE: _____ LONGITUDE: _____

CHART #: _____ TOPO MAP #: _____

IS THIS WORK: ___ PROPOSED ___ EXISTING ___ MODIFICATION OF EXISTING

IS THE UPLAND OWNER THE SAME AS THE APPLICANT? YES ___ NO ___

IF NOT, WHO IS THE UPLAND OWNER? _____

WILL CONSTRUCTION INVOLVE BLASTING OR DRILLING? YES ___ NO ___

SIGNATURE: _____
 TITLE: _____
 DATE: _____

-----SAMPLE APPLICATION-----

***SaskPower* - DISTRIBUTION STANDARDS**

DRN.	DESIGN CHK.	APPROVAL	LETTER OF APPLICATION	
CHKD.				
DATE	DATE	DATE		
DATE OF ISSUE	2009/06/29	DRAWING NO: C-24-22.02	SHEET 1 OF 1	REV. A

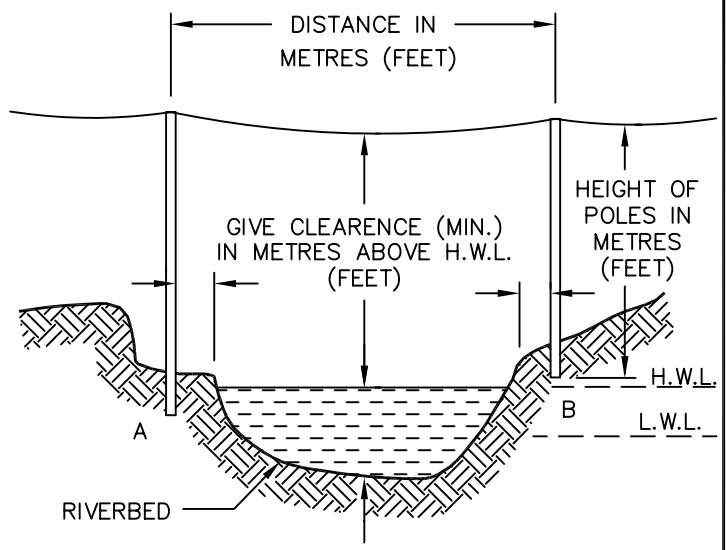
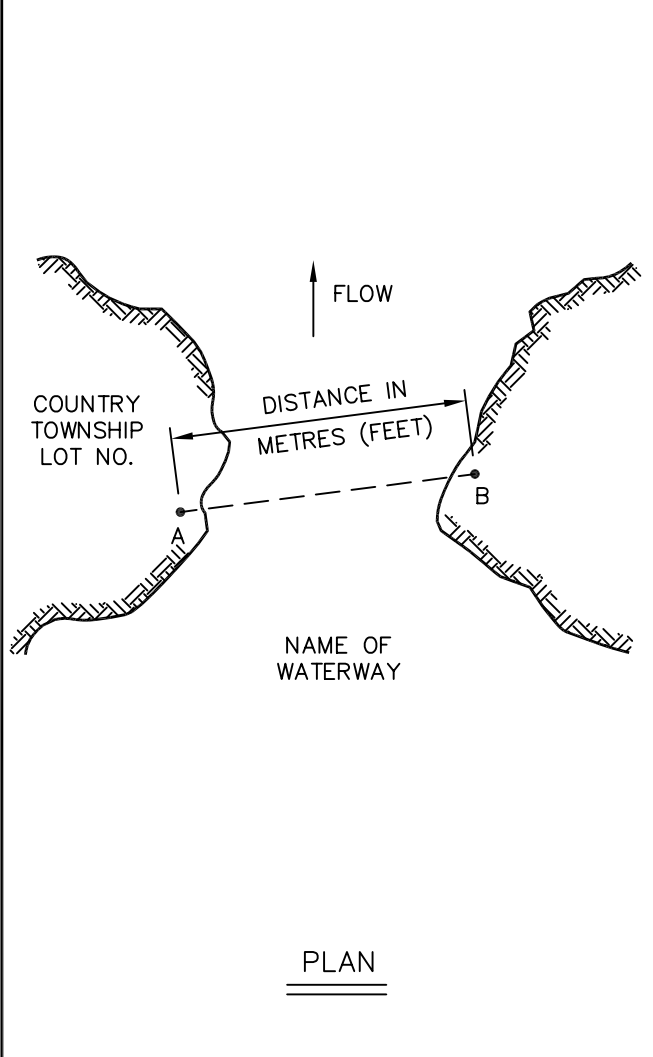
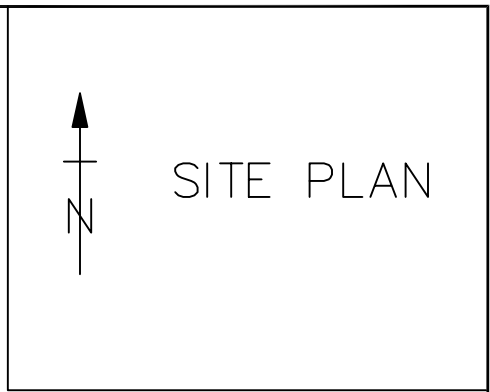

SOUNDINGS REQUIRED EVERY 7.62m (25 FEET) TO SHOW PROFILE

NOTE:
 INDICATE LATITUDE AND LONGITUDE OF TERMINAL POINTS OR REFERENCE POINT TO ESTABLISHED BENCHMARK AND ALL ELEVATIONS TO GEODETIC DATUM
 ALL WATER LEVELS SHOULD BE RELATED TO CHART DATUM.

OVERHEAD CROSSING PLAN

SAMPLE APPLICATION

RENUMBERED, PREVIOUS DRAWING C-24-22.03

SaskPower – DISTRIBUTION ENGINEERING

DRN. <i>R</i>	DESIGN CHK.	APPROVAL	OVERHEAD CROSSING PLAN
CHKD.			
DATE	DATE	DATE	
DATE OF ISSUE		DRAWING NO. C-24-22.04	SHEET 1 of 1 REV. 0